



10th International Conference on Green Technology 2019

PROGRAM BOOK

International Conference on Green Technology 2019

Empowering the 4.0 Industrial Revolution through Green Science and Technology

October 2nd - 3rd, 2019

at Savana Hotel and Convention Malang

Sponsored by :



PT. Dharma Karya Makmur Sentosa

Ruko Surya Inti Permata Jl. Jemur Andayani 50 Blok D 8-9 Surabaya- Indonesia
Phone. 02 (31) 8418284, 8476971 Fax. 02 (31) 8418476



GeneCraft Labs

thermoscientific

Organized by :



IOP Conference Series
Materials Science and Engineering

ALCHEMY
Journal of Chemistry



CAUCHY
Jurnal Matematika Murni dan Aplikasi

NEUTRINO
Jurnal Fisika dan Aplikasinya

MATICS
Jurnal Ilmu Komputer dan Teknologi Informasi
(Journal of Computer Science and Information Technology)

Plan Schedule

The 10th International Conference on Green Technology (ICGT)

Day 1: October 2nd 2019

Venue: Savana Hotel and Convention, Jl. Letjen Sutojo No. 76 Malang, East Java, Indonesia

Time	Agenda	Location
07.00 - 07.30	Registration	
07.30 – 07.40	Topeng Malangan Dance	Mahoni Room
07.40 – 07.50	Opening	Mahoni Room
07.50 – 07.55	Recitation of the Holy Qur'an	Mahoni Room
07.55 – 08.00	Indonesia Raya "Singing"	Mahoni Room
08.00 - 09.00	Welcoming Speech from 1. Chairperson of 10 th ICGT 2. Dean of Science and Technology Faculty UIN Malang 3. Rector of UIN Malang	Mahoni Room
09.00 - 09.30	Plenary session 1 Speaker: Prof. Fumihiro Morishita Moderator: Romaidi, M.Si., D.Sc. Title: Identification of Neuropeptides in Gastropod Mollusks.- Classical and Brand-new Approaches	Mahoni Room
09.30 - 10.00	Plenary session 2 Speaker: Mohamad Saufi Bin Rosmi, PhD. Moderator: Romaidi, M.Si., D.Sc. Title: Construction of Bio-Template C- Doped g-C ₃ N ₄ -Based Hybrid Nanocomposites with Enhanced Visible-Light Photocatalytic Activity	Mahoni Room
10.00 - 10.20	Company Talk/Technical Presentation	Mahoni Room
10.20 - 10.35	Coffee Break	
10.35 – 11.05	Plenary session 3 Speaker: Prof. Kanokwan Poomputsa Moderator: Ahmad Mujahidin, M.Sc Title: A genetically defined virus inoculum for production of <i>Spodoptera exigua</i> multiple nucleopolyhedrovirus in insect cell culture with enhanced insecticidal activity	Mahoni Room
11.05 - 11.35	Plenary session 4 Speaker: Eriyanto Yusnawan, Ph.D Moderator: Ahmad Mujahidin, M.Sc Title: Beneficial Role of Trichoderma in Agriculture: A Study in Leguminous Plants	Mahoni Room
11.35 – 11.45	Souvenir giving for keynote speaker and photo session with keynote speaker	Mahoni Room
11.45 - 12.15	Poster session 1 Poster assesor:	Mahoni Corridor

	<ol style="list-style-type: none"> 1. Prof. Fumihiro Morishita 2. Mohamad Saufi Bin Rosmi, PhD. 3. Prof. Kanokwan Poomputsa 4. Eriyanto Yusnawan, Ph.D 5. Dr. Anton Prasetyo, M.Si 6. Romaidi, M.Si., D.Sc. 7. Rachmawati Ningsih, M.Si 	
12.15 - 13.00	Lunch	
13.00 - 15.15	Parallel session	
	Room 1 (Scope A) Invited speaker: Prof. Drs. Wasinton Simanjuntak, M.Sc, Ph.D Title: The effect of crystallization time on structure, microstructure, and catalytic activity of zeolite-A synthesized from rice husk silica and food grade aluminum foil Moderator: <ul style="list-style-type: none"> - Session 1: Ari Satia Nugraha, S.F., G.Dipsc., M.Sc., Ph.D., Apt. - Session 2: Dr. Dede Suhendar, M.Si - Session 3: Anggita Rahmi Hafsari, M.Si 	Mahoni A
	Room 2 (Scope C-F) Invited speaker: Ass. Prof. Phenjun Mekvichitsaeng Title: Pilot Scale production of Aurantiochytrium limanicum JS607 for feed to promote DHA content in chicken flesh and egg Moderator: <ul style="list-style-type: none"> - Session 1: Wahri Sunanda, S.T., M.Eng. - Session 2: Prof. Dr. Ir. Diana Arfiati, MS. - Session 3: Tina Dewi Rosahdi, S.Pd., M.Si. 	Mahoni B
	Room 3 (Scope F) Invited speaker: Ass. Prof. Wairuj Dechmahitkul Title: Pilot scale production of Boletus colossus culture for promoting growth of Para Rubber Trees. Moderator: <ul style="list-style-type: none"> - Session 1: Dr. Mita Rilyanti, S.Si., M.Si. - Session 2: Ayda Krisnawati, M.P., M.Sc. - Session 3: Bawon Triatmoko, S.Farm., M.Sc., Apt. 	Meranti
	Room 4 (Scope B-G) Invited speaker: Dr. Sri Harini, M.Si. Title: Determination Of Customer Price Index With Generalized Space Time Autoregressive Moderator: <ul style="list-style-type: none"> - Session 1: Dr. Elis Ratna Wulan, MT. - Session 2: Nita Yalina, S.Kom., M.MT. - Session 3: Yusuf Wibisono, S.TP., M.Sc., Ph.D. 	Eboni
15.15 - 15.30	Coffee Break	
15.30 - 17.00	Parallel session continued	Mahoni -Meranti-Eboni

Day 2: October 3rd 2019

Venue: Savana Hotel and Convention, Jl. Letjen Sutojo No. 76 Malang, East Java, Indonesia

Time	Agenda	Location
07.30 - 08.00	Registration	
08.00 – 08.30	Plenary session 5 Speaker: Dr. rer. nat. habil. Ulrike Schmidt Moderator: Nur Aini, M.Si Title:	Mahoni Room
08.30 - 09.00	Plenary session 6 Speaker: Dr. Akyunul Jannah, S.Si, MP. Moderator: Nur Aini, M.Si Title: Potential of Rice Barn as A Natural Antioxidant and Antibacterial Compound	Mahoni Room
09.00 - 09.30	Plenary session 7 Speaker: Prof. Drs. Darsono, M.Sc Moderator: Nur Aini, M.Si Title: Application of Electron Accelerator for Flue Gas Treatment of Coal Power Plant to Support Green Technology	Mahoni Room
09.30 – 09.50	Company Talk/Technical Presentation	Mahoni Room
09.50 - 10.05	Coffee Break	
10.05 - 10.35	Plenary session 8 Speaker: Dr. Wasilah Sihabuddin, ST.MT.. Moderator: Ari Kusumastuti, M.Pd Title: Behavior Architecture Implementation In Special School Design	Mahoni Room
10.35 – 11.05	Plenary session 9 Speaker: Dr. Kiptiyah, M.Si Moderator: Ari Kusumastuti, M.Pd Title: The Potency of 10-gingerol as A Primary Candidate to become An Anti-cancer Agent: Study of Cumulus Cell	Mahoni Room
11.05 – 11.15	Souvenir giving for keynote speaker and photo session with keynote speaker	Mahoni Room
11.15 - 11.45	Poster Session 2 Poster assesor : 1. Dr. Akyunul Jannah, S.Si, MP 2. Prof. Drs. Darsono, M.Sc 3. Dr. Wasilah Sihabuddin, ST.MT 4. Dr. Kiptiyah, M.Si 5. Dr. Anton Prasetyo, M.Si 6. Romaidi, M.Si, D.Sc. 7. Rachmawati Ningsih, M.Si	Mahoni Corridor
11.45 - 13.00	Lunch	
13.00 - 15.00	Parallel session	

	Room 1 (Scope D) Chairperson: Moderator: - Session 1: Dr. Ir. Nyoman Puspa Asri, MS. - Session 2: Muhammad Ma'arij Harfadli, ST., MT.	Mahoni A
	Room 2 (Scope E) Chairperson: Moderator: - Session 1: Tarranita Kusumadewi, MT. - Session 2: Ir. Agung Murti Nugroho, ST., MT., Ph.D.	Mahoni B
	Room 3 (Scope A-D) Chairperson: Moderator: - Session 1: Rachmawati Ningsih, M.Si - Session 2: A. Ghanaim Fasya, M.Si	Meranti
	Room 4 (Scope B-E-F-G) Chairperson: Moderator: - Session 1: Dr. Roihatul Mutiah, SF., M.Kes, Apt. - Session 2: Agus Subaqin, ST., MT.	Eboni
15.00 – 15.15	Academic report	Mahoni Room
15.15 – 15.30	Closing ceremony	Mahoni Room

Note: The schedule can change according to certain circumstances and considerations during the event.

Parallel Session Schedule

Scope of The Conference are :

Scope A : Enviromental Impact Evaluation

Scope B : Enviromental Education

Scope C : Human Ecology

Scope D : Sustainable Environmental Technology

Scope E : Green Architecture and Design

Scope F : Energy and Ecological Conservation

Scope G : Green Smart Technology and Innovation

Day 1: October 2nd 2019, 13.00 - 17.00

	Mahoni A	Mahoni B	Eboni	Meranti
	SCOPE A	SCOPE C-F	SCOPE F	SCOPE B-G
Schedule	Moderator: - Session 1: Ari Satia Nugraha, S.F., G.Dipsc., M.Sc., Ph.D., Apt. - Session 2: Dr. Dede Suhendar, M.Si - Session 3: Anggita Rahmi Hafsari, M.Si	Moderator: - Session 1: Ir. Ahmad Syauqi, M.Si. - Session 2: Prof. Dr. Ir. Diana Arfiati, MS. - Session 3: Ni Komang Ayu Agustini, M.Eng	Moderator: - Session 1: Dr. Mita Rilyanti, S.Si., M.Si - Session 2: Ayda Krisnawati, M.P., M.Sc. - Session 3: Bawon Triatmoko, S.Farm., M.Sc., Apt.	Moderator: - Session 1: Dr. Elis Ratna Wulan, MT. - Session 2: Adit Ludfi Pradana - Session 3: Mega Ulimaz, ST. MT.
13.00-13.15	<u>Invited speaker:</u> Prof. Drs. Wasinton Simanjuntak, M.Sc, Ph.D <u>Title:</u> The effect of crystallization time on structure, microstructure, and catalytic activity of zeolite-A synthesized from rice husk silica and food grade	<u>Invited speaker:</u> Ass. Prof. Phnjun Mekvichitsaeng <u>Title:</u> Pilot Scale production of Aurantiochytrium limanicum JS607 for feed to promote DHA content in chicken flesh and egg	<u>Invited speaker:</u> Ass. Prof. Wairuj Dechmatikul <u>Title:</u> Pilot scale production of Boletus colossus culture for promoting growth of Para Rubber Trees.	<u>Invited speaker:</u> Dr. Sri Harini, M.Si. <u>Title:</u> Determination Of Customer Price Index With Generalized Space Time Autoregressive

	aluminum foil			
13.15-13.27	ABS-33 Dede Suhendar	ABS-40 Diana Arfiati	ABS-70 Ayda Krisnawati	ABS-39 Adit Ludfi P.
13.27-13.39	ABS-15 Lyli Mufidah	ABS-7 Maisuna Kundariati	ABS-13 Erliana Ginting	ABS-71 Sujianto
13.39-13.51	ABS-35 Dewinta Sari S.	ABS-90 Yusmani Prayogo	ABS-44 Sutini	ABS-84 Deden Mudiana
13.51-14.03	ABS-58 Siti Dian Rosadi	ABS-34 A'yunil Hisbiyah	ABS-47 Arie Hardian	ABS-12 Nita Yalina
14.03-14.15	ABS-66 Arie Febrianto M.	ABS-55 Firman Satria Pamungkas	ABS-69 Fakhry W.	ABS-111 Galuh Citra Cahya
14.15-14.27	ABS-85 Anggita Rahmi H.	ABS-16 Ni Komang Ayu A.	ABS-101 Bawon Triatmoko	ABS-26 Mega Ulimaz
14.27-14.39	ABS-81 Anis Arzia M.	ABS-74 Anita Dewi P.	ABS-152 Noor Suzilawati R.	ABS-118 Lilin Indrayani
14.39-14.51	ABS-96 Ahmad Ashov B.	ABS-125 Mutlara Triwiswara	ABS-77 Evy Ratnasari E.	ABS-52 Widyastuti
14.51-15.03	ABS-117 Solikin	ABS-56 Ardita Eliyanti	ABS-79 Ummy Mardiana	ABS-48 Yusuf Wibisono
15.03-15.15	ABS-124 Andy Wijanarko	ABS-49 Fanriyanto Sampe	ABS-93 ApriSulistyo	ABS-151 Masnia Ningsih
15.15-15.30	Coffee Break			
15.30-15.42	ABS-105 Ari Satia N.	ABS-43 Ahmad Syauqi	ABS-126 Mita Rilyanti	ABS-60 Elis Ratna Wulan
15.42-15.54	ABS-137 Arief Harsono	ABS-10 Wahri Sunanda	ABS-73 Sutopo	ABS-14 Buyung Al F.
15.54-16.06	ABS-138 Anggita Rahmi H.	ABS-53 Felisitas Utami	ABS-154 Titut Yulistyarini	ABS-114 Mimin F. R.
16.06-16.18	ABS-128 Parnidi	ABS-72 Resky Irfanita	ABS-159 Laily Mukarromah	ABS-134 Muhammad I. H.
16.18-16.30	ABS-116 Ilim	ABS-75 Sari Wahyuni	ABS-102 Antonius Nugraha	ABS-4 Imam Cholissodin
16.30-16.42	ABS-132 Eko Prabowo H.	ABS-133 Tety Sudiarti	ABS-22 Herdis H.	ABS-9 Ina Yulianingtiyas

16.42-16.54	ABS-143 Soni Sasori	-	ABS-6 Agus Wibowo	ABS-88 Syamsudin
16.54-17.06	-	-	ABS-25 Fifi Nurfiana	-

Day 2: October 3rd 2019, 13.00 - 15.00

Schedule	Mahoni A	Mahoni B	Eboni	Meranti
	SCOPE D	SCOPE E	SCOPE A-D	SCOPE B-E-F-G
	Chairperson: Dr. Kiptiyah, M.Si Moderator: - Session 1: Dr. Ir. Nyoman Puspa Asri, MS. - Session 2: Muhammad Ma'arij Harfadli, ST., MT.	Chairperson: Dr. Yulia Eka Ptrie Moderator: - Session 1: Ir. Agung Murti Nugroho, ST., MT., Ph.D.	Chairperson: Dr. Akyunul Jannah, S.Si, MP. Moderator: - Session 1: Rachmawati Ningsih, M.Si - Session 2: A. Ghanaim Fasya, M.Si	Chairperson: Eriyanto Yusnawan, Ph.D Moderator: - Session 1: Agus Subaqin, ST., MT. - Session 2: Dr. Roihatul Mutiah, SF., M.Kes, Apt.
13.00-13.15	ABS-31 Muhammad M. H.	ABS-42 Agung Murti N.	ABS-173 A.Ghanaim	ABS-38 Roihatul Mutiah
13.15-13.27	ABS-36 Eviomitta Rizki A.	ABS-41 Pingkan Nuryanti	ABS-129 Rahmi Annisa	ABS-109 Fachrur Rozi
13.27-13.39	ABS-63 Idra Herlina	ABS-78 Susilo Bekti	ABS-166 Eny Yulianti	ABS-163 Khusnul Yakin
13.39-13.51	ABS-119 Gesa Gustami P.	ABS-110 Ristina Siti Sundari	ABS-64 Yusuf Hendrawan	ABS-164 Khusnul Yakin
13.51-14.03	ABS-92 Yuastutik	ABS-23 Maya Fadhillah	ABS-68 Erna Hastuti	ABS-18 Fakhris K. R. M.
14.03-14.15	ABS-158 N.P. Asri	ABS-103 Nunik Junara	ABS-59 Rachmawati N.	ABS-106 Agus Subaqin
14.15-14.27	ABS-127 Pramudia B. D.	-	ABS-83 Arief Yuwono	ABS-107 Luluk Maslucha
14.27-14.39	ABS-153 Ardhana R.	-	ABS-145 Diana Candra D.	ABS-108 Pudji Pratitis W.
14.39-14.51	-	-	ABS-20 Choirun Nisa	ABS-104 Aisyah H.
14.51-15.03	-	-	-	ABS-160 M. Royanudin

Note: The schedule can change according to certain circumstances and considerations during the event.

ROOM LAYOUT of 10th ICGT 2019

1st Floor : Mahoni Room

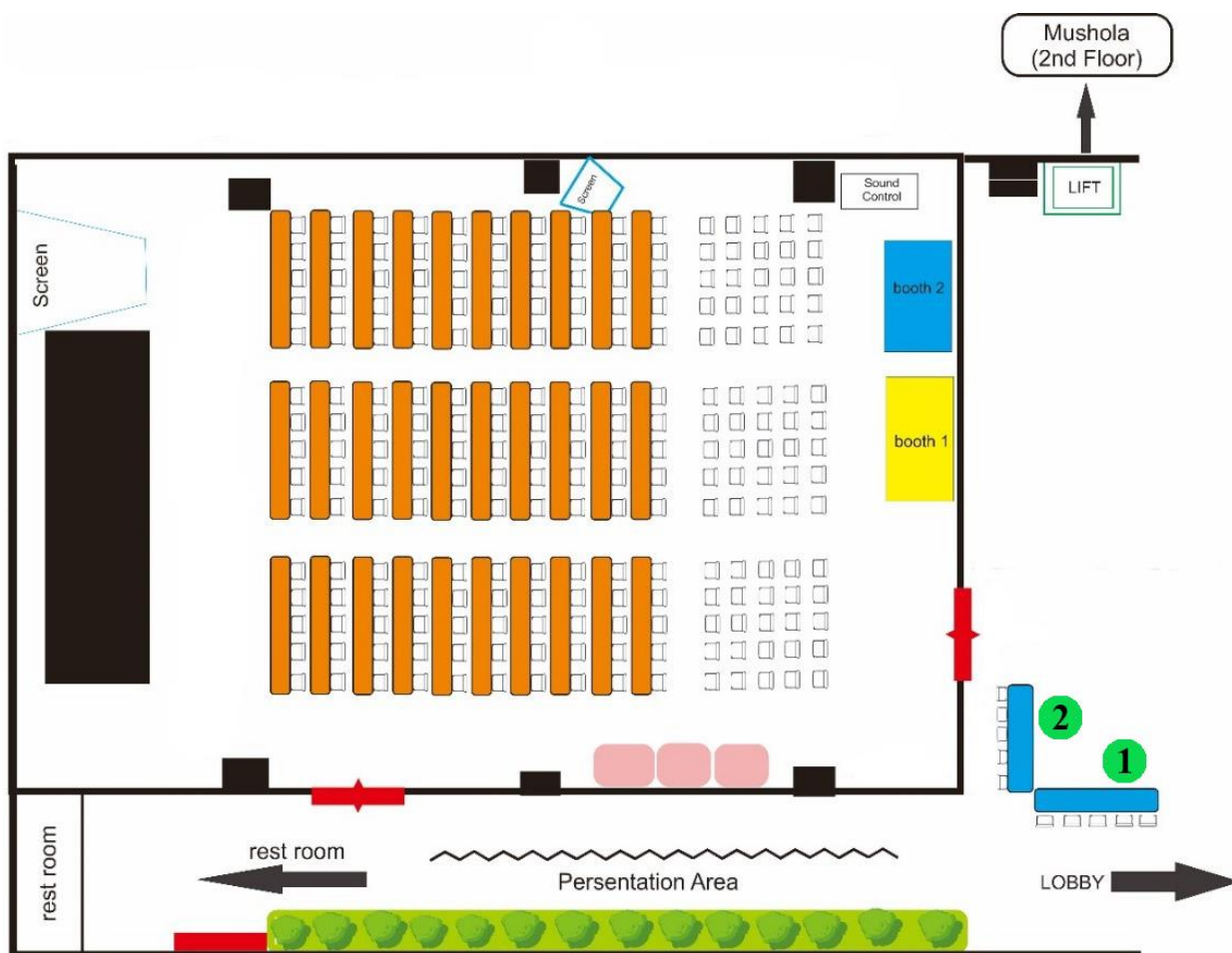

Note :

- 1 Payment Checklist
- 2 Registration

Participants are expected to go to Payment Checklist desk and Registration desk before entering the room.

3rd Floor : Meranti Room

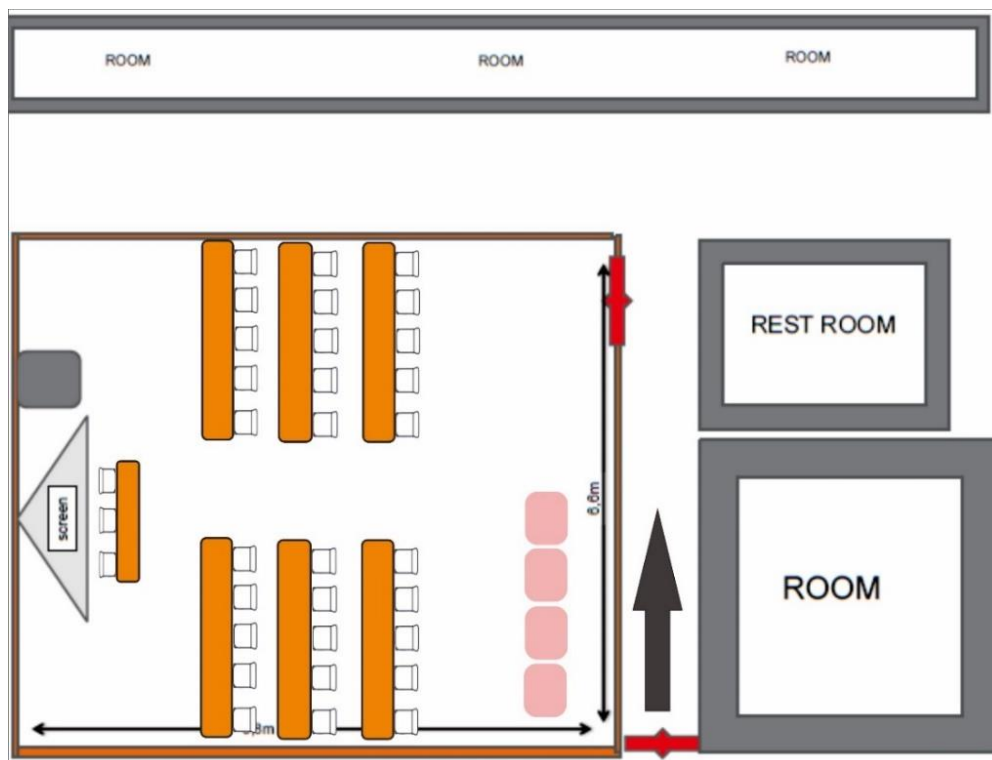

5th Floor : Eboni Room

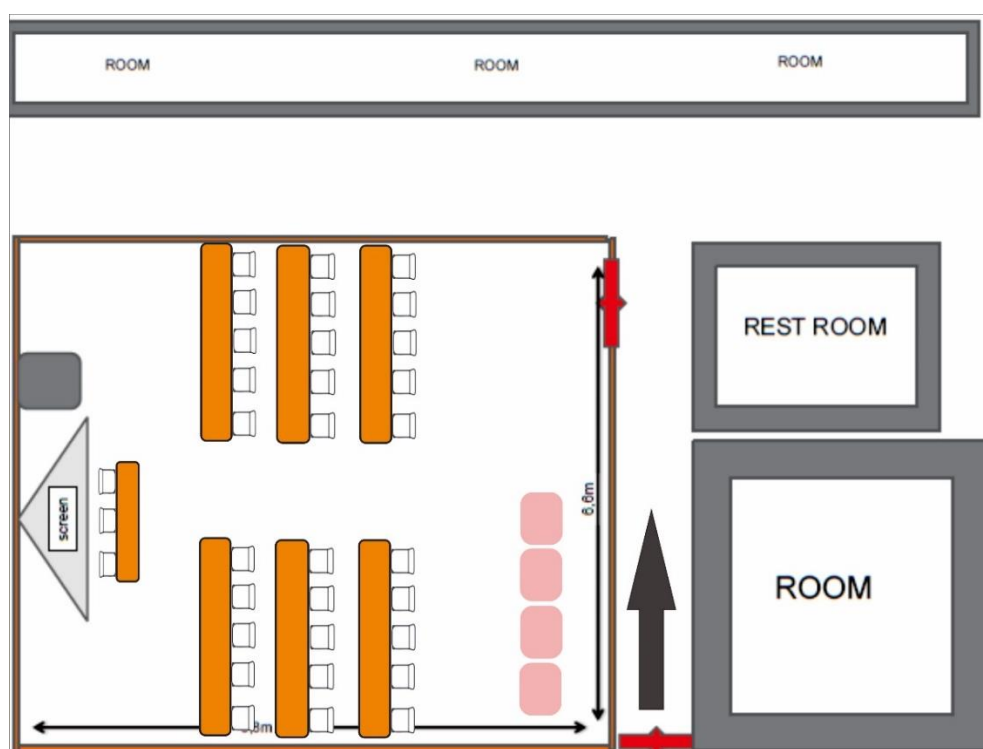

SYMPOSIUM AT GLANCE

Day 1: October 2nd 2019					
Venue: Savana Hotel and Convention, Jl. Letjen Sutojo No. 76 Malang, East Java, Indonesia					
Time	Selasar	Mahoni A	Mahoni B	Eboni	Meranti
07.00	Registration				
07.15					
07.30		Opening			
07.45					
08.00		Welcoming Speech			
08.15					
08.30					
08.45					
09.00		Plenary Session 1			
09.15					
09.30		Plenary Session 2			
09.45					
10.00		Company Talk or Technical Presentation			
10.05	Coffee Break				
10.35		Plenary Session 3			
10.35					
11.05		Plenary Session 4			
11.35					
11.35		Flash Presentation			
12.05					
12.15	Lunch				
12.30					
13.00					
13.00	Parallel Session				
15.00	Academic Report				
15.15	Closing ceremony				

Day 2: October, 3rd 2019					
Venue: Savana Hotel and Convention, Jl. Letjen Sutojo No. 76 Malang, East Java, Indonesia					
Time	Selasar	Mahoni A	Mahoni B	Eboni	Meranti
07.00	Registration				
07.15					
07.30					
07.45					
08.00		Plenary Session 5			
08.15					
08.30		Plenary Session 6			
08.45					
09.00		Plenary Session 7			
09.15					
09.30	Coffee Break				
09.45		Plenary Session 8			
10.00					
10.15		Plenary Session 9			
10.30					
10.45		Company Talk or Technical Presentation			
11.00					
11.15		Flash Presentation			
11.30					
11.45	Lunch				
12.00					
12.15					
12.30					
12.45					
13.00	Parallel Session				
14.00					
15.00	Closing ceremony				

GUIDELINES

All Participants

1. Please attend the entire conference program, so that speaker will not be disappointed because of small audience. Conference is to hear and exchange ideas. So the presenter will have enthusiasm to deliver the research result in front of a plenty audience participation, and there will be feed back ideas between presenter and audience.
2. Please do not smoke and talk in the room.
3. Please silent your mobile phone.
4. Participants are welcome to choose parallel rooms and please ask only short and clear questions.
5. Certificates will be given at the end of the symposium On October, 3 2019.

Plenary speaker

1. Presentation time is scheduled by the committee.
2. The room will be equipped with a LCD projector, and an official PC. The committee does not recommend the presenter to use a personal computer. Presentation file should be written in Microsoft Power Point.
3. Please send the PPT file to the committee one day before your presentation schedule.
4. The presentation file will be used only for the presentation and will not be used for other purposes. The committee will delete the file after the conference.
5. Time for presentation is about 20 minutes. Discussion in parallel is about 10 minutes.

Invited Speaker

1. Presentation time is scheduled by the committee.
2. The room will be equipped with a LCD projector, and an official PC. The committee does not recommend the presenter to use a personal computer. Presentation file should be written in Microsoft Power Point.
3. Please send the PPT file to the committee one day before your presentation schedule.
4. The presentation file will be used only for the presentation and will not be used for other purposes. The committee will delete the file after the conference.
5. Time for presentation is about 20 minutes and discussion about 10 minutes.

Oral Presenter

1. Presentation time is scheduled by the committee.
2. The room will be equipped with a LCD projector, and an official PC. The committee does not recommend the presenter to use a personal computer. Presentation file should be written in Microsoft Power Point.
3. Please send the PPT file to the committee one day before your presentation schedule.
4. The presentation file will be used only for the presentation and will not be used for other purposes. The committee will delete the file after the conference
5. Time for presentation is about 8 minutes. Discussion in parallel is about 10 minutes.
6. Certificate as oral presenter will be given to 1 presenter (the one who presented the talk) per presentation at the end of the conference.

Poster Presentation

1. All posters should be on the designated poster numbers from 08.00 am to 05.00 pm on the assigned day.
2. The poster session will take place for 30 minutes, as scheduled.
3. Presenters should be stand up near their poster when the poster presentation time.
4. Certificate as poster presenter will be given to 1 presenter (the one who presented the poster) per presentation at the end of the conference.

Physical Dimension

- The poster should be printed in A1 size (**59.4 × 84.1 cm** or **23.4 × 33.1 in**).
- We will provide you assistance in setting up your poster before the session starts.

Writing Styles

- **The title** should be written as short as possible (*not more than 15 words*). The title should be centred, and in **Arial 60-point** boldface type.
- **Author names** are to be centred beneath the title and printed in **Arial 40-point** boldface type. The full name is preferred and written without the use of the title and the fullname is preferred and specify institutional affiliation.
- **Abstract** should be written in **Arial 24-point** and **at least 5 keywords**

- **The introduction** should describe the background and issues briefly but full of contents at this point. This should *no more than 8 lines*, written in **Arial 24-point**.
- **The experimental result** should be written brief enough, 1-2 sentences in **Arial 24-point**.
- **The result and discussion** should describe the findings clearly, written in **Arial-24 point**, completed by *diagram, chart or pictures* to simplify the content thus helping the viewers to understand the information.
- **The conclusion** should be written in pointer format, in **Arial 24-point**.
- **References** should be written in pointer format, in **Arial 24-point**
- **The contact person** should contain a *corresponding author's e-mail address, phone number and the insitution identity*.

<div>  <div> TITLE OF RESEARCH STUDY The title should be written as short as possible (<i>not more than 15 words</i>). The title should be centred, and in Arial 60-point boldface type. </div> </div> <div> Author Names And Affiliation Author names are to be centred beneath the title and printed in Arial 40-point boldface type. The full name is preferred and written without the use of the title and The fullname is preferred and specify institutional affiliation </div>		
Abstract Abstract should be written in Arial 24-point and at least with 5 keyword	Result and Discussion Result and Discussion should describe the findings clearly, written in Arial 24-point , completed by <i>diagram, chart or pictures</i> to simplify the content thus helping the viewers to understand the information.	
Introduction introduction should describe the background and issues briefly but full of contents at this point. This should <i>no more than 8 lines</i> , written in Arial 24-point .		
Experimental Research Experimental Research should be written brief enough, 1-2 sentences in Arial 24- point .	Conclusion conclusion should be written in pointer format, in Arial 24-point .	References References should be written in pointer format, in Arial 24-point .
Contact Person Contact Person should contain a <i>corresponding author's e-mail address, phone number and the institution identity</i> .		

ORAL PRESENTATION SCHEDULE

ORAL PRESENTATION SCHEDULE				
Nama	ID	Day	Room	Time
A.Ghanaim	ABS-173	3 Oct	EBONI	13.00-13.15
Adit Ludfi Pradana	ABS-39	2 Oct	MERANTI	13.51-14.03
Agung Murti Nugroho	ABS-42	3 Oct	MAHONI B	13.00-13.12
Agus Subaqin	ABS-106	3 Oct	MERANTI	14.03-14.15
Agus Wibowo	ABS-6	2 Oct	EBONI	16.30-16.42
Ahmad Ashov Birry	ABS-96	2 Oct	MAHONI A	14.39-14.51
Ahmad Syauqi	ABS-43	2 Oct	MAHONI B	15.54-16.06
Aisyah Handryant	ABS-104	3 Oct	MERANTI	14.39-14.51
Akhmad Rizali	ABS-57	3 Oct	EBONI	14.15-14.27
Andy Wijanarko	ABS-124	2 Oct	MAHONI A	15.03-15.15
Anggita Rahmi Hafsari	ABS-85	2 Oct	MAHONI A	14.15-14.27
Anggita Rahmi Hafsari	ABS-138	2 Oct	MAHONI A	15.54-16.06
Anis Arzia Muntiani	ABS-81	2 Oct	MAHONI A	14.27-14.39
Anita Dewi Permatasari	ABS-74	2 Oct	MAHONI B	14.27-14.39
Antonius Nugraha Widhi Pratama	ABS-102	2 Oct	EBONI	16.06-16.18
Apri Sulisty	ABS-93	2 Oct	EBONI	14.51-15.03
Ardhana Rahmayanti	ABS-153	3 Oct	MAHONI A	14.39-14.51
Ardita Elliyanti	ABS-56	2 Oct	MAHONI B	14.51-15.03
Ari Satia Nugraha	ABS-105	2 Oct	MAHONI A	15.30-15.42
Arie Febrianto Mulyadi	ABS-66	2 Oct	MAHONI A	14.03-14.15
Arie Hardian	ABS-47	3 Oct	MAHONI B	13.27-13.39
Arief Yuwono	ABS-83	3 Oct	EBONI	14.15-14.27
Arief Harsono	ABS-137	2 Oct	MAHONI A	15.42-15.54
Asep Supriadin	ABS-130	2 Oct	MAHONI B	13.00-13.15
Ayda Krisnawati	ABS-70	2 Oct	EBONI	13.15-13.27
A'Yunil Hisbiyah	ABS-34	2 Oct	MAHONI B	13.51-14.03
Bawon Triatmoko	ABS-101	2 Oct	EBONI	14.15-14.27
Buyung Al Fanshuri	ABS-14	2 Oct	MERANTI	15.42-15.54
Choirun Nisa	ABS-20	3 Oct	EBONI	14.39-14.51
Dede Suhendar	ABS-33	2 Oct	MAHONI A	13.15-13.27
Deden Mudiana	ABS-84	2 Oct	MERANTI	13.39-13.51
Dewinta Sari Sunarya	ABS-35	2 Oct	MAHONI A	13.39-13.51
Diana Arfiati	ABS-40	2 Oct	MAHONI B	13.15-13.27
Diana Candra Dewi	ABS-145	3 Oct	EBONI	14.27-14.39
Eko Prabowo Hadisantoso	ABS-132	2 Oct	MAHONI A	16.30-16.42
Elis Ratna Wulan	ABS-60	2 Oct	MERANTI	15.30-15.42
Eny Yulianti	ABS-166	3 Oct	EBONI	13.27-13.39
Erliana Ginting	ABS-13	2 Oct	EBONI	13.27-13.39
Erna Hastuti	ABS-68	3 Oct	EBONI	14.15-15.03
Eviomitta Rizki Amanda	ABS-36	3 Oct	MAHONI A	13.15-13.27

Evy Ratnasari Ekawati	ABS-77	2 Oct	EBONI	14.27-14.39
Fachrur Rozi	ABS-109	3 Oct	MERANTI	13.15-13.27
Fakhris Khusnu Reza Mahfud	ABS-18	3 Oct	MERANTI	13.51-14.03
Fakhry Wirapratama	ABS-69	2 Oct	EBONI	13.51-14.03
Fanriyanto Sampe	ABS-49	2 Oct	MAHONI B	15.42-15.54
Felisitas Utami	ABS-53	2 Oct	MAHONI B	16.06-16.18
Fifi Nurfiana	ABS-25	3 Oct	MAHONI B	14.15-14.27
Galuh Citra Cahya Rohmana	ABS-111	2 Oct	MERANTI	14.03-14.15
Gesa Gustami Pangesti	ABS-119	3 Oct	MAHONI A	14.51-15.03
Hendro Juwono	ABS-55	2 Oct	MAHONI B	14.03-14.15
Herdis Herdiansyah	ABS-22	2 Oct	EBONI	16.18-16.30
Idra Herlina	ABS-63	3 Oct	MAHONI A	13.27-13.39
Ilim	ABS-116	2 Oct	MAHONI A	16.18-16.30
Imam Cholissodin	ABS-4	2 Oct	MERANTI	16.18-16.30
Khusnul Yakin	ABS-163	3 Oct	MERANTI	13.00-13.15
Khusnul Yakin	ABS-164	3 Oct	MERANTI	13.39-13.51
Laily Mukarromah	ABS-159	2 Oct	EBONI	15.54-16.06
Lilin Indrayani	ABS-118	2 Oct	MERANTI	14.27-14.39
Luluk Maslucha	ABS-107	3 Oct	MERANTI	14.15-14.27
Lyli Mufidah	ABS-15	2 Oct	MAHONI A	13.27-13.39
Maisuna Kundariati	ABS-7	2 Oct	MAHONI B	13.27-13.39
Masnia Ningsih	ABS-151	2 Oct	MERANTI	15.03-15.15
Maya Fadhillah	ABS-23	3 Oct	MAHONI B	14.27-14.39
Mega Ulimaz	ABS-26	2 Oct	MERANTI	14.51-15.03
Mimin Fatchiyatur Rohmah	ABS-114	2 Oct	MERANTI	15.54-16.06
Mita Rilyanti	ABS-126	2 Oct	EBONI	15.30-15.42
Moch. Royanudin	ABS-160	3 Oct	MERANTI	14.51-15.03
Muhammad Ismail Hasan	ABS-134	2 Oct	MERANTI	16.06-16.18
Muhammad Ma'Arij Harfadli	ABS-31	3 Oct	MAHONI A	13.00-13.15
Mutiara Triwiswara	ABS-125	2 Oct	MAHONI B	14.39-14.51
N.P. Asri	ABS-158	3 Oct	MAHONI A	14.03-14.15
Ni Komang Ayu Agustini	ABS-16	2 Oct	MAHONI B	15.03-15.15
Nita Yalina	ABS-12	2 Oct	MERANTI	13.15-13.27
Noor Suzilawati Rabe	ABS-152	2 Oct	EBONI	14.03-14.15
Nunik Junara	ABS-103	3 Oct	MAHONI B	14.39-14.51
Nunung Kurniasih	ABS-121	3 Oct	MAHONI A	14.15-14.27
Parnidi	ABS-128	2 Oct	MAHONI A	16.06-16.18
Pingkan Nuryanti	ABS-41	3 Oct	MAHONI B	13.15-13.27
Pramudia Bagus Dewangga	ABS-127	3 Oct	MAHONI A	14.27-14.39
Pudji Pratitis Wismantara	ABS-108	3 Oct	MERANTI	14.27-14.39
Rachmawati Ningsih	ABS-59	3 Oct	EBONI	13.51-14.03
Rahmi Annisa	ABS-129	3 Oct	EBONI	13.15-13.27
Resky Irfanita	ABS-72	2 Oct	MAHONI B	16.18-16.30
Ristina Siti Sundari	ABS-110	3 Oct	MAHONI B	13.51-14.03
Roihatul Mutiah	ABS-38	3 Oct	MERANTI	13.27-13.39

Sari Wahyuni	ABS-75	2 Oct	MAHONI B	16.30-16.42
Siti Dian Rosadi	ABS-58	2 Oct	MAHONI A	13.51-14.03
Solikin	ABS-117	2 Oct	MAHONI A	14.51-15.03
Soni Setiadji	ABS-76	3 Oct	MAHONI A	13.39-13.51
Soni Sasori	ABS-143	2 Oct	MAHONI A	16.42-16.54
Sri Harini	ABS-170	2 Oct	MERANTI	13.00-13.15
Sujianto	ABS-71	2 Oct	MERANTI	13.27-13.39
Susilo Bakti	ABS-78	3 Oct	MAHONI B	13.39-13.51
Sutini	ABS-44	2 Oct	EBONI	13.39-13.51
Sutopo	ABS-73	2 Oct	EBONI	15.03-15.15
Syamsudin	ABS-88	2 Oct	MERANTI	16.42-16.54
Tety Sudiarti	ABS-133	2 Oct	MAHONI B	16.42-16.54
Tina D.R	ABS-135	2 Oct	MAHONI B	14.15-14.27
Titut Yulistyarini	ABS-154	2 Oct	EBONI	15.42-15.54
Ummy Mardian	ABS-79	2 Oct	EBONI	14.39-14.51
Wahri Sunanda	ABS-10	2 Oct	MAHONI B	15.30-15.42
Wairuj Dechmahitkul	ABS-51	2 Oct	EBONI	13.00-13.15
Wasinton Simanjunta	ABS-115	2 Oct	MAHONI A	13.00-13.15
Widyastuti	ABS-52	2 Oct	MERANTI	14.39-14.51
Yuastutik	ABS-92	3 Oct	MAHONI A	13.51-14.03
Yusmani Prayogo	ABS-90	2 Oct	MAHONI B	13.39-13.51
Yusuf Hendrawan	ABS-64	3 Oct	EBONI	13.39-13.51
Yusuf Wibisono	ABS-48	2 Oct	MERANTI	14.15-14.27

Day 1 : October, 2th 2019

Room Paralel Scope A (Mahoni A)

Time	ID/Code	Presenter & Title	
13.00-13.15	ABS-115	Wasinton Simanjuntak	The Effect Of Crystallization Time On Structure, Microstructure, and Catalytic Activity Of Zeolite-A Synthesized From Rice Husk Silica And Food Grade Aluminum Foil
13.15-13.27	ABS-33	Dede Suhendar	Understanding The Requirements For Wudhu (Ablution) Water Volume Based On Changes In Chemical Oxygen Demand For Several Days
13.27-13.39	ABS-15	Lyli Mufidah	Conversion Dau Citrus Farm To Organic: An Improvement Discourse. A Review
13.39-13.51	ABS-35	Dewinta Sari Sunarya	Utilization of Baglog Waste as Bokashi Fertilizer with Local Microorganisms (MOL)
13.51-14.03	ABS-58	Siti Dian Rosadi	Economic Valuation of Mangrove Ecosystem at Kebun Ayu Village, West Lombok Regency

14.03-14.15	ABS-66	Arie Febrianto Mulyadi	The Technical and Financial Feasibility Analysis on the Establishment of a Waste-Processing Unit for Coconut Shell (Liquid Smoke and Activated Carbon)
14.15-14.27	ABS-85	Anggita Rahmi Hafsari	Bioplastic Quality Analysis of Kombucha Celululose for Post-Harvest Fruit Packaging Material
14.27-14.39	ABS-81	Anis Arzia Muntiani	The Impact of Agricultural Activities in Drawdown Area On Sustainability of Delingan Reservoir Function
14.39-14.51	ABS-96	Ahmad Ashov Birry	Population Density, Human Development Index, Priority Watersheds and Voluntary Disclosure of Pollutant Release Data by Textile Companies in Indonesia
14.51-15.03	ABS-117	Solikin	Cropping Patterns and Plants Diversity in Agroforests in Wringin Village Subdistrict of Wringin Bondowoso East Java
15.03-15.15	ABS-124	Andy Wijanarko	The Response of Several Groundnut Cultivars on Fertilization in Dry Lands with Dry Climate
15.15-15.30	Coffee Break		
15.30-15.42	ABS-105	Ari Satia Nugraha	Searching For Antimalarial Agent From Indonesian Euodia Suaveolens
15.42-15.54	ABS-137	Arief Harsono	Productivity Of Soybean Under Palm Oil Plantation On Tidal Swamps Due To Several Packages Of Technology
15.54-16.06	ABS-138	Anggita Fahmi Hafsari	Molecular Identification Of Phosphate Solubilizing Bacteria Isolate 1 Bp. 2 With 16s Rrna Genes From Karst Citatah Area
16.06-16.18	ABS-128	Parnidi	Kenaf Plant Resistance On The Root Gall Nematodes (<i>Meloidogyne Incognita</i>)
16.18-16.30	ABS-116	Ilim	Comparative study of CO ₂ Corrosion inhibition of mild steel in brine solution by the oligomers of 2-vinylpyridine and 4-vinylpyridine
16.30-16.42	ABS-132	Eko Prabowo Hadisantoso	Synthesis of Fe ₂ O ₃ Nanoparticle from battery waste for photocatalytic treatment of methylene blue
16.42-16.54	ABS-143	Soni Sascori	preparation of zeolite-Y from rice husk silica and food grade aluminium foil as catalyst for co-pyrolisis of mixed cassava tuber and palm oil

Room Paralel Scope C & F (Mahoni B)

Time	ID/Code	Presenter & Title	
13.00-13.15	ABS-130	Asep Supriadin	Larvicides Effects Of Extract Ethyl Acetate <i>Aglaia glabrata</i> Leaves and Its Fractination To <i>Aedes aegypti</i> Larvae
13.15-13.27	ABS-40	Diana Arfiati	Analysis Of Food Habits Tilapia (<i>Oreochromis niloticus</i>) That Caught In Sangiran Reservoir, Ngawi, East Java
13.27-13.39	ABS-7	Maisuna Kundariati	Vegetation Analysis Using Point Centered Quarter (PCQ) Method in Border Forest of Jembrana Buleleng West Bali National Park (TNBB)
13.39-13.51	ABS-90	Yusmani Prayogo	Biological control of <i>Bemisia tabaci</i> Gennadius by using entomopathogenic fungi <i>Aschersonia aleyrodis</i>
13.51-14.03	ABS-34	A'Yunil Hisbiyah	Extraction and Characterization of Nanocellulose from Sugarcane Bagasse by Ultrasonication Method
14.03-14.15	ABS-55	Hendro Juwono	Utilization of Polystyrene Waste with Biodiesel From Cooking Oil Waste as Feedstock in Catalytic Cracking Using Al-MCM-41/Ceramic and Pd/Al-MCM-41/Ceramic Catalysts
14.15-14.27	ABS-135	Tina D.R.	Screening of Bacterial Isolate and Extracellular Enzyme Identification in Mangrove root Sediments From Mangrove Forest Labuhan Maringgai, East Lampung
14.27-14.39	ABS-74	Anita Dewi Permatasari	Heavy Metal and Harmful Liquid Waste Membranes Based on Geopolymer Fly-Ash/TiO ₂ -Rgo
14.39-14.51	ABS-125	Mutiara Triwiswara	Utilization of Black Tea Waste as Batik Natural Dyes on Cotton and Silk
14.51-15.03	ABS-56	Ardita Elliyanti	Influence of Biodiesel Waste Coconut Oil on Produce Hydrocarbon Fraction by Catalytic Cracking Waste Polystyrene and its Application in Gasoline Engine
15.03-15.15	ABS-16	Ni Komang Ayu Agustini	Water to Solid Ratio Effect on Thermal Conductivity of Fly Ash-Based Geopolymers Paste
15.15-15.30	Coffee Break		
15.30-15.42	ABS-10	Wahri Sunanda	Utilization photovoltaic as a source of hybrid power plant in Celagen Island
15.42-15.54	ABS-49	Fanriyanto Sampe	Thermal Properties of Geopolymers with Silica Fume
15.54-16.06	ABS-43	Ahmad Syauqi	Turbidity of <i>Saccharomyces cerevisiae</i> : A Proposed Cell Quantification Method
16.06-16.18	ABS-53	Felisitas Utami	Thermal conductivity of geopolymer with polypropylene fiber
16.18-16.30	ABS-72	Resky Irfanita	The Influence of Reduced Graphene Oxide

			Nanoparticles (rGO NPs) on The Microstructure of Metakaolin Geopolymer
16.30-16.42	ABS-75	Sari Wahyuni	Synthesis and Characterization of Green Material for Heat Protection Based on Metakaolin Geopolymer-MgO NPs Composite
16.42-16.54	ABS-133	Tety Sudiarti	Potential of Kenikir Leaf Extract (<i>Cosmos caudatus</i>) as Corrosion Inhibitor of Iron in 1% NaCl Solution

Room Paralel Scope F (Ebony)

Time	ID/Code	Presenter & Title	
13.00-13.15	ABS-51	Wairuj Dechmahitkul	Pilot scale production of <i>Boletus colossus</i> culture for promoting growth of Para Rubber Trees.
13.15-13.27	ABS-70	Ayda Krisnawati	Assessment of Agronomic Performance and Shattering Resistance of F7 Soybean Lines
13.27-13.39	ABS-13	Erliana Ginting	Selected Purple-Fleshed Sweet Potato Genotypes with High Anthocyanin Contents
13.39-13.51	ABS-44	Sutini	Disinfecting Technology of <i>Camellia sinensis</i> L Inoculants Through In Vitro Culture
13.51-14.03	ABS-69	Fakhry Wirapratama	Effect of Ethanol Extract of Wungu (<i>Graptophyllum pictum</i> L. (Griff)) Leaf on Histological Observation of Testes on Male Mice Induced Cadmium Sulphate
14.03-14.15	ABS-152	Noor Suzilawati Rabe	An Assessment of Early Warning System: Initial Survey Analysis
14.15-14.27	ABS-101	Bawon Triatmoko	Preliminary study on antimalarial agent from Indonesian <i>Swietenia mahogany</i>
14.27-14.39	ABS-77	Evy Ratnasari Ekawati	Detection of <i>Staphylococcus aureus</i> in Infection Wounds on the Skin Surface
14.39-14.51	ABS-79	Ummy Mardiana	The Potential of Biocatalyst from Traditional Market Waste Water for Microbial Fuel Cell
14.51-15.03	ABS-93	Apri Sulistyio	Selection of early-generation soybean lines resistant to whitefly using SSR markers
15.03-15.15	ABS-73	Sutopo	Release Test of N, P, and K of Complete Slow Release Fertilizer (PUKAP JESTRO-1) and Its Effect on the Growth of Young Siam Citrus (<i>Citrus nobilis</i> Lour.)
15.15-15.30	Coffee Break		
15.30-15.42	ABS-126	Mita Rilyanti	Catalytic Performance of Hierarchical ZSM-

			5 Synthesized from Sugarcane Bagasse Ash in Transesterification Reaction of Coconut Oil for Biodiesel Production
15.42-15.54	ABS-154	Titut Yulistyarini	Reproductive Activity Pattern of Four Species of <i>Cinnamomum</i> In Purwodadi Botanic Garden
15.54-16.06	ABS-159	Laily Mukarromah	Assessment of Vegetation Cover through+D37+D14 Red-Edge Spectral Reflectance-Based Indices
16.06-16.18	ABS-102	Antonius Nugraha Widhi Pratama	<i>Senna occidentalis</i> : Indonesian leguminose as source for antimalarial agent
16.18-16.30	ABS-22	Herdis Herdiansyah	Applying material flow analysis for estimating the amount of personal computers e-waste
16.30-16.42	ABS-6	Agus Wibowo	The combustion step and the change in the final length of combustion in jatropha oil by increasing the spray pressure

Room Paralel Scope B & G (Meranti)

Time	ID/Code	Presenter & Title	
13.00-13.15	ABS-170	Sri Harini	Determination of Customer Price Index With Generalized Space Time Autoregressive
13.15-13.27	ABS-12	Nita Yalina	Digital Workplace : Digital Transformation for Environmental Sustainability
13.27-13.39	ABS-71	Sujianto	Development Status and Challenges of Organic Rice Farming in Indonesia
13.39-13.51	ABS-84	Deden Mudiana	Field Notes: Terrestrial Orchids in the Lappadata Forest, Bone, South Sulawesi
13.51-14.03	ABS-39	Adit Ludfi Pradana	Green Technique for the Extraction of Acid Soluble Collagen from Basa Fish (<i>Pangasianodon hypophthalmus</i>)
14.03-14.15	ABS-111	Galuh Citra Cahya Rohmana	Bricketting Polystyrene Waste with Thermal Decomposition as Friendly Environmental Boiler Fuel
14.15-14.27	ABS-48	Yusuf Wibisono	Design and evaluation of mobile ultrafiltration-based point-of-use drinking water treatment for low income communities
14.27-14.39	ABS-118	Lilin Indrayani	Implementation Green Industry Standard at Textile Industry And Textile Product
14.39-14.51	ABS-52	Widyastuti	Design for Temperature Distribution of Continuous Furnace System for Sintering Application
14.51-15.03	ABS-26	Mega Ulimaz	Green infrastructure Pattern of the

			Manggar Riverside as Minapolitan Settlement
15.03-15.15	ABS-151	Masniah Ningsih	Message Communication Strategy in Management of Waste Bank Centong Village Gondang Mojokerto District
15.15-15.30	Coffee Break		
15.30-15.42	ABS-60	Elis Ratna Wulan	Completion Neutrosophic Transportation Problem Type 1 Using Zero Point Method
15.42-15.54	ABS-14	Buyung Al Fanshuri	Simulation of Climate Change Impact on Maize Growth and Production Using DSSAT Modeling
15.54-16.06	ABS-114	Mimin Fatchiyatur Rohmah	Predicting the City and Districts Consumer Price Index in East Java with the Gaussian-Radial Basis Function Kernel
16.06-16.18	ABS-134	Muhammad Ismail Hasan	Implementation of TF.IDF Weighting and Latent Semantic Indexing on Information Retrieval System for Indonesian Health Articles
16.18-16.30	ABS-4	Imam Cholissodin	Detection of Hijab Syar'i as Smart Clothes for Moslem People using High Performance of Parallel Computing
16.30-16.42	ABS-9	Ina Yulianingtiyas	Competence of Small Medium Enterprise Employees to Implement ISO 14001:2015
16.42-16.54	ABS-88	Syamsudin	Conceptual Model of Smart Sustainable Environment City: Literature Review

Day 2: October, 3th 2019

Room Paralel Scope D (Mahoni A)

Time	ID/Code	Presenter & Title	
13.00-13.15	ABS-31	Muhammad Ma'Arij Harfadli	The Effect of Nozzle Size On Dissolved Oxygen Value Using Fine Bubble Aeration. Case Study: Leachate Treatment in TPA Manggar
13.15-13.27	ABS-36	Eviomitta Rizki Amanda	Antimicrobial Film Based on Lemon Oil Emulsion-Impregnated Agarose/Chitosan
13.27-13.39	ABS-63	Idra Herlina	Biodiesel Preparation from Oil Fraction of Crude Pond Palm Oil through $\text{SiO}_2/\text{SO}_3\text{-H}^+$ -Catalyzed Esterification Followed by KOH-Catalyzed Transesterification
13.39-13.51	ABS-76	Soni Setiadji	Effect of Precipitation Time Assisted by Ultrasonication for Synthesis of ZnO Photocatalyst
13.51-14.03	ABS-92	Yuastutik	Utilization of Geothermal Sludge as a Material for Making Zeolite Polymer Nanoparticles Composites

14.03-14.15	ABS-158	N.P. Asri	Biodiesel Production from Kesambi (<i>Schleichera oleosa</i>) Oil using Multi-Walled Carbon Nanotubes Supported Zinc Oxide as a Solid Acid Catalyst
14.15-14.27	ABS-121	Nunung Kurniasih	Methyl Rocaglate From The Stembark Of <i>Aglaia minahassae</i> (Meliaceae) And Its Cytotoxic Activity Against Hela Cervical Cancer Cell Lines
14.27-14.39	ABS-127	Pramudia Bagus Dewangga	Pyrolysis of Polystyrene Plastic Waste Using Bentonite Catalyst
14.39-14.51	ABS-153	Ardhana Rahmayanti	Synthesis and Characterization of Silica Gel from Lapindo Mud Sidoarjo
14.51-15.03	ABS-119	Gesa Gustami Pangesti	Transesterification of Coconut Oil Using MgO Doped Zeolite-Y Prepared from Rice Husk Silica

Room Paralel Scope E (Mahoni B)

Time	ID/Code	Presenter & Title	
13.00-13.15	ABS-42	Agung Murti Nugroho	The Tropical Living Wall System as Passive Cooling House Strategy : A review
13.15-13.27	ABS-41	Pingkan Nuryanti	Analysis of Hydraulic Sluice Gate Sapon - Intake In Progo River DIY
13.27-13.39	ABS-47	Arie Hardian	Synthesis, Characterization, and Evaluiton of ZrO_2 - $ZnFe_2O_4$ Composite Ceramics as a Magnetic Photocatalyst for Methylene Blue Degradation
13.39-13.51	ABS-78	Susilo Beki	Community Accompaniment at RW 16, Mangliawan Village, Pakis District, Malang Regency to Create a Clean and Green Environment
13.51-14.03	ABS-110	Ristina Siti Sundari	Aquaponic: From Innovation of Hobby Lead to Food
14.15-14.27	ABS-25	Fifi Nurfiana	Degradation Kinetics of Methylene Blue With Photocatalyst TiO_2
14.27-14.39	ABS-23	Maya Fadhillah	The Diversity and Abundance of Mammals in The High Conservation Value Forest in Palm Oil Plantation, Solok Selatan, West Sumatra
14.39-14.51	ABS-103	Nunik Junara	Study of House Orientation and their Placement towards Sustainable Islamic Residential Area

Room Paralel Scope A-D (Eboni)

Time	ID/Code	Presenter & Title	
13.00-13.15	ABS-173	A. Ghanaim	Farmacology Potency of Thin Layer Chromathography Steroid Isolates of <i>Chlorella Sp</i> Chloroform and Ethyl Acetate Fraction
13.15-13.27	ABS-129	Rahmi Annisa	UHPLC Analysis of the 1,4 Naphthoquinone in the Indonesian Medicinal Plant <i>Eleutherine palmifolia (L) Merr</i>
13.27-13.39	ABS-166	Eny Yulianti	modification of corn stalk using citric acid as biosorbent for methylene blue
13.39-13.51	ABS-64	Yusuf Hendrawan	Modeling and Optimization of Palm Oil Moisture Loss as Biodiesel Pretreatment
13.51-14.03	ABS-59	Rachmawati Ningsih	Synthesis of Schiff Base Compound from Vanillin and Aniline with Volume Variations of Acid Catalyst from Belimbing Wuluh Using Grindstone Method
14.03-14.15	ABS-57	Akhmad Rizali	Utilization of <i>Bacillus thuringiensis</i> in controlling armyworms (<i>Spodoptera litura</i>) on Tomato (<i>Solanum lycopersicum</i>) Plants
14.15-14.27	ABS-83	Michelle Natali	Development of Ecosystem Health Index in Rural Areas of Java Island:Preliminary Results
14.27-14.39	ABS-145	Diana Candra Dewi	green synthesis of gold nanoparticles using biomoleculs extract of ketapang leaf (<i>Terminalia catappa</i>) and noni (<i>morinda citrifolia L.</i>) fruit
14.39-14.51	ABS-20	Choirun Nisa	Testing of <i>Trichoderma Sp.</i> Formulation On Pathogen Prevention Of <i>Fusarium Oxysporum</i> Causes Of Wilt In Capsicum Frutescens In Vivo

Room Paralel Scope B-E-F-G (Meranti)

Time	ID/Code	Presenter & Title	
13.00-13.15	ABS-163	Khusnul Yakin	The Simulation of Mechanical Excitement Effect on Bone Density Due to the Age Changes Based on Finite Element Method (FEM)
13.15-13.27	ABS-109	Fachrur Rozi	Performance Evaluation of The Revised Double Sampling X' Chart Based on Median Run Length with Estimated Parameter
13.27-13.39	ABS-38	Roihatul Mutiah	New compounds of pregnanone from <i>Calotropis gigantea</i> roots actively against colon cancer cell WiDr through cell cycle inhibition

13.39-13.51	ABS-164	Khusnul Yakin	The Simulation of Mechanical Stimulation Effect on Bone Elasticity Limit Based on Finite Element Method (FEM)
13.51-14.03	ABS-18	Fakhris Khusnu Reza Mahfud	Sentiment Analysis of National Libraries Through Social Media Twitter
14.03-14.15	ABS-106	Agus Subaqin	Rebranding Effort for Public and Private Territories In The Riverbank Settlements Of Kampung Tridi Malang
14.15-14.27	ABS-107	Luluk Maslucha	Contribution of Bamboo Materials In Architecture Education Towards Sustainable Community Development
14.27-14.39	ABS-108	Pudji Pratitis Wismantara	Socio-Ecological Perspective in Nusantara Architecture Knowledges Construction
14.39-14.51	ABS-104	Aisyah Handryant	Integrated Sustainability Index Of East Surabaya With Casbee Tools Towards Sustainable City
14.51-15.03	ABS-160	Moch. Royanudin	Silica-Cellulose Gel as Immobilization Matrix for Pseudomonas fluorescens Bacteria

POSTER SCHEDULE SESSION: DAY 1

The poster sessions will be held after plenary sessions at **11.45 A.M - 12.15 P.M.**, and authors should attend their posters to answer questions of delegates.

Poster Number	Abs ID	Title	Author	Scope
01	ABS-86	Callus Metabolites Induction Noni (<i>Morinda citrifolia</i> L.) Using Combination 2,4-Dichlorophenoxy Acetic acid and 6-Benzylaminopurine in Vitro	Muhammad Farid Annas	A
02	ABS-87	Influence of Chitosan for Anatomy Structure and Antraquinon Content of Metabolites Callus Noni (<i>Morinda citrifolia</i> L.)	Muhammad Farid Annas	A
03	ABS-97	The potency of macrozoobenthos diversity at Ledok Amprong River as practicum source for biology student	Soraya Habibi	A

04	ABS-130	Larvicides Effects Of Extract Ethyl Acetate <i>Aglaia glabrata</i> Leaves and Its Fractination To <i>Aedes aegypti</i> Larvae	Asep Supriadin	A
05	ABS-132	Synthesis of Fe ₂ O ₃ Nanoparticle from battery waste for photocatalytic treatment of methylene blue	Eko Prabowo Hadisantoso	A
06	ABS-139	Response of Groundnut Promising Lines to Various Environments	Joko Purnomo	A
07	ABS-140	Pod Yield and Haulm Weight Peanut Cultivars Grown in DY Lands with Dry Climate	Agustina Asri Rahmianna	A
08	ABS-175	Potential Use of Compounds from Neem Leaf (<i>Azadirachta indica</i> juss) as PPRG and ESRα Inhibitors to Control Breast Cancer Cell Growth	Supriyanto	A
09	ABS-201	The Increased Yield of Rice due Application of High-Potassium-NPK Fertilizer to Low-Potassium-Soil Content	Nurul Istiqomah	A
10	ABS-19	How to Design Information Technology by Ergonomic Aspect at University Library	Firma Sahrul Bahtiar	B
11	ABS-24	The application of the green architecture principles of TRI HARSONO KARYONO to design natural tourism in Pasuruan	Afni Krisnawangse h	B
12	ABS-182	Estimation of carbon absorption potential, biomass, and carbon deposit monitoring in the city of Malang	Gita Niken Madapuri	B
13	ABS-183	Statistical Analysis of Student Statisfaction in Facilities and Services at Scince and Technology Faculty of UIN Malang	Helliyatus Saadah	B
14	ABS-190	Inventory and prevalence of milkfish (<i>chanos-chanos</i>) digestive tract in Malang City traditional market	Esamada rose nursaputri	B

15	ABS-120	The Implementation of Ethical Concepts toward Waste in the Design of Farms and the Cultivation of Ducks in Mojokerto	Abdul Hafid Al Manuddin	C
16	ABS-135	Screening of Bacterial Isolate and Extracellular Enzyme Identification in Mangrove Root Sediments From Mangrove Forest Labuhan Maringgai, East Lampung	Tina D.R.	C
17	ABS-141	Effect of Fertilization and Shoot Tip Pruning on The Growth of Sambiloto (<i>Andrographis paniculata</i> (Burm. f.) Nees	Solikin	C
18	ABS-150	The Influence of Phosphorus Fertilizer on Growth and Yield of Maize on Dry Land	Wahyu Handayati	C
19	ABS-156	Green energy from waste: Modification of methyl orange dye as a light harvester on solar cell	Harsasi Setyawati	C
20	ABS-8	Sonochemical Synthesis of SrTiO ₃ /TiO ₂ Heterojunction Material	Vina Nurul Istighfarini	D
21	ABS-11	Effect of Synthesis Time on Particle Size of Bi ₄ Ti ₃ O ₁₂ Synthesized by Molten Single Salt NaCl Method	Anton Prasetyo	D
22	ABS-32	Synthesis and Characterization of Nanoparticle Maghemite (γ -Fe ₂ O ₃) as Pigment from Lathe Waste Using Sonication – Calcination Method	Lilik Miftahul Khoiroh	D
23	ABS-37	The Effect of Organic Fertilizer from Household Waste and Liquid Organic Fertilizer on Growth and Yield of Pakcoy (<i>Brassica few L.</i>)	Amik Krismawati	D
24	ABS-62	Detection Limit Response Time Quartz Crystal Microbalance (QCM) in Cow Gelatin and Pig Gelatin Based on Trioctyl Methyl Ammonium Chloride Membran	Muthmainnah	D

25	ABS-76	Effect of Precipitation Time Assisted by Ultrasonication for Synthesis of ZnO Photocatalyst	Soni Setiadji	D
26	ABS-121	Methyl Rocaglate from The Stembark of <i>Aglaia Minahassae</i> (<i>Meliaceae</i>) and Its Cytotoxic Activity Against Hela Cervical Cancer Cell Lines	Nunung Kurniasih	D
27	ABS-144	anticancer activity in 2-methoxy-4-((4-methoxyphenylimino)methyl)phenol compound on T47D breast cancer cells	Elok Kamilah Hayati	D
28	ABS-155	Preliminary study on the site-specific nutrient fertilization efficiency through several tools	Donald Sihombing	D
29	ABS-157	Potential Growth and Production of Rice (<i>Oryza sativa</i>) with Additional Applications of Liquid Inorganic Micro Leaf Fertilizer	Sugiono	D
30	ABS-65	Concept The Design of Community Pesantren Development in Sumberpucung Malang Using Symbiosis Architecture Approach	Bakhrur Roji Setya Nung Nurwana	E
31	ABS-67	Application of Sensory Therapeutic Design Approach to Maternal and Child Hospital Design in Kecamatan Sumbermanjing Wetan	Nunik Junara	E
32	ABS-82	Enterprise Architecture Zachman Framework in Ma'had Sunan Ampel Al'Aly	Selvi Dwi Granita	E
33	ABS-112	Organic Architecture Approach in Designing a Surabaya Zoo	Airlangga Cahya Hardiwibawa	E
34	ABS-131	The Application of Ecological Architecture in Designing Hotel Resort of Lenggoksono Beach	Faulia R.A	E

35	ABS-142	The Application of "Gupuh Lungguh And Suguh" in The Design of Coffee Education Tourism in Banyuwangi	Ainur Rofiqoh	E
36	ABS-45	Effectiveness of Macro Compound NK Fertilization on Growth and Yield of Corn	lina aisyawati	F
37	ABS-122	Hydrogen Bond on Conformational Change During the Movement of Lid lipMNK	Dian Herasari	F
38	ABS-123	Preparation of ZSM-5 from Rice Husk Silica and Aluminum Foil Using Tetrapropylammonium Bromide (TPABr) as aTemplate	Kamisah Delilawati Pandiangan	F
39	ABS-17	The Effect of Addition Mn^{2+} Metal Ions and Incubation Time to Bacillus cereus Cellulase Enzyme Activity from Endophytic Bacteria of Curcuma Rhizome (<i>Curcuma zanthorrhiza Roxb.</i>)	Cahyaning Sulistyantini	G
40	ABS-21	Removal of Lead(II) From Aqueous Solution Using waste HVS paper as a low-cost adsorbent	Vina Amalia	G
41	ABS-28	Synthesis and Characterization of Pigment Hematite ($\alpha\text{-Fe}_2\text{O}_3$) nanoparticles from Iron Lathe Waste Using Sonication–Calcination Method	Lilik Miftahul Khoiroh	G
42	ABS-29	Ethnobotany Mendong Plants (<i>Fimbristylis globosa</i>) as Handicrafts in The Wajak District of Malang Regency	Eko Budi Minarno	G
43	ABS-46	Exact solution to the Klein-Gordon Equation on Modified Schwarzschild Black Holes	Arista Romadani	G
44	ABS-61	ERP Enhancement of the Purchase and Warehouse Module in the Era of Industrial Revolution 4.0	Eka Puji Rahayu Lestari	G

POSTER SCHEDULE SESSION DAY 2

The poster sessions will be held after plenary sessions at **11.15-11.45 A.M.**, and authors should attend their posters to answer questions of delegates.

Poster Number	Abs ID	Title	Author	Scope
45	ABS-177	Response of Date Palm Seeds (<i>Phoenix dactylifera</i> L. var. <i>Mozafati</i>) Using Various Scarifications Through in Vitro Culture	Safira Rachmadani Nur Effendi	A
46	ABS-178	Ethnobotanical Research of Plants for Traditional Ceremony Mitoni Used by Community of Mojosari, Mojokerto	Diah Lailil Rahmawati	A
47	ABS-181	Isolation of Low Density Polyethylene (LDPE) Degrading Bacteria from Supit Urang Landfill, Malang Regency	Dwi Putri Ayu Wardani	A
48	ABS-188	Analysis Contamination of Microplastic in Bottled Water Based on FTIR and E-Tongue Using LDA and PCA Method	Silvi Nadya Margareta	A
49	ABS-195	Study of Focal Mechanism and Peak Ground Intensity to find out The Fault Types and The Extent of Physical Damage for Lombok Earthquakes on 2018	Dimas Ario Pamungkas	A
50	ABS-203	Exploration, negotiation, and the antioxidant activity test of local sorghum plants to make Indonesia free of type 2 diabetes mellitus	Bahrul Fikri Anzwar	A
51	ABS-208	Analysis Pollution Water River Based E-Tongue Using The Principal Component Analysis Method and Analysis Discriminate Linear	Aep Muhaemin	A
52	ABS-27	Parallel Approach in Rank Based Association Rule Mining	Okta Qomaruddin Aziz	C

53	ABS-98	Comparison Between Chemical and Natural Treatments for Bamboo as Building Material towards Sustainable Construction Method	Ernaning Setiyowati	C
54	ABS-168	Amphibian (Order Anura) Diversity in Tourism Area of Coban Putri, Coban Jahe, Coban Pelangi, and Ledok Amprong, Malang Region, East Java	Berry Fakhry Hanifa	C
55	ABS-169	Seagrass Vegetation Analysis on The Coast of Hadir and Batu Lawang Beach Karimunjawa National Park	Muhammad Asmuni Hasyim	C
56	ABS-199	Participatory Action Research: Maternal and Child Health System	Mohamad Alif Irfan Anshori	C
57	ABS-94	Synthesis of material composite rGO-TiO ₂ from coconut shells by sol-gel method	Utiya Hikmah	D
58	ABS-95	The Effect of Microwave Irradiation on Reduced Graphene Oxide from Coconut Shells	Diah Risma Yanti	D
59	ABS-146	Potential of Extract Rice bran fermented by <i>Rhizopus oryzae</i> as Antibacterial against <i>Salmonella typhi</i>	Akyunul Jannah	D
60	ABS-147	Synthesis and Characterization of Alginate-Cellulose Beads from Corn Stalk And Application as Adsorbent for methylene blue	Eny Yulianti	D
61	ABS-149	Porous Alginate/Cellulose Xanthate Beads From Corn Stalk With CaCO ₃ And NaCl As Porogens	Eny Yulianti	D
62	ABS-161	Preparation, Anticancer Test and Drug Release Study of Doxorubicin (DOX) supported NaX zeolite against breast cancer cells (T47D)	Elok Kamilah Hayati	D

63	ABS-165	Immunomodulatory Activity of Exopolysaccharides Produced by <i>Leuconostoc mesenteroides</i> Strains Isolated from Palm (<i>Borassus flabellifer</i> L.) Sap	Anik Ma'unatin	D
64	ABS-167	adsorption isotherm and thermodynamic of malachite green on corn stalk (<i>zea mays</i> L.) modified citric acid	Eny Yulianti	D
65	ABS-171	Isolation, Identification and Bioactivity of Steroids Isolates from <i>Hydrilla Verticillata</i> Petroleum Ether Fraction	A. Ghanaim	D
66	ABS-172	Antioxidant Activity and Toxicity Test of Steroid Compound in Column Chromatography Isolates of <i>Chlorella</i> sp.n-Hexane Fraction	Rynanda Ajeng Pratiwi	D
67	ABS-174	The Effect of Acid Variation on Physical and Chemical Characteristics of Cellulose Isolate from <i>Saccharum Officinarum</i> L. Bagasse	B. Fauziyah	D
68	ABS-185	A Comparison Study on the Synthesis of Fe^{3+} and Cu^{2+} -Doped MnO_2 as an Energy Storage	Wahyu Reni Agustin	D
69	ABS-192	Synthesis of $\text{CaTi}_{10.95}\text{Fe}_{0.05}\text{O}_3$ and $\text{CaTi}_{10.9}\text{Fe}_{0.1}\text{O}_3$ Material using Molten Single Salt NaCl Method	Dwi Rahayu Novianti	D
70	ABS-194	Synthesis of Gallium (III) Doped Mesoporous Titanium Dioxide Using Sonochemical Method	Yolanda Sintia Dewi	D
71	ABS-196	Sintesis dan Karakterisasi Zeolit Faujasit dari Kaolin Blitar dengan Penambahan Templat Organik	R. E. Hardianty	D
72	ABS-204	Ultrasonic anti-cancer activity test of S47D soursop leaf extract (<i>Annona muricata</i> linn)	Amila Rahmawati	D

73	ABS-89	Characteristics of Petung Bamboo as The Main Structure of Wide Span Bamboo Hall Building at Gubukklakah, Poncokusumo, Malang	S Maulana Aji Ali Busthomy	E
74	ABS-99	Store Facade Renovation for Heritage Architecture	Arief Rakhman Setiono	E
75	ABS-136	The Eco-Cultural Approach Intergrating Islamic Values with Artha Wantilan Concept on The Fish Market Desing in Kedonganan Bali	Tarranita Kusumadewi	E
76	ABS-162	The usage of Bamboo Material as An Aesthetic Finishes towards Green and Environmentally Friendly Architecture	Sukmayati Rahmah	E
77	ABS-184	Application of Islamic Architecture Approach on Designing Integrated Hajj Dormitory of Malang City	Ayuningtyas	E
78	ABS-187	Sidoarjo Mud Volcano Memorial Park	Sayyidatul Abidah	E
79	ABS-91	Construction analysis of the string motion model on sasando musical instrument	Ari Kusumastuti	G
80	ABS-176	Development of Remotely Operated Vehicles (ROV) Underwater for Underwater Exploration Using Proportional-Integral-Derivative (PID)	Rizqi Ari putra	G
81	ABS-179	The Influence of Service Quality and Previous Experience as a Moderator to Tourist Satisfaction in Batu With Partial Least Square Approach	Angga Dwi Mulyanto	G
82	ABS-180	Application of Sensory Therapeutic Design Approach to Maternal and Child Hospital Design in Kecamatan Sumbermanjing Weta	Dini sa'adah alim	G

83	ABS-186	A Comparative on Double Barrier Option Pricing Using Antithetic Variate and Control Variate Monte Carlo Simulations	Abdul Aziz	G
84	ABS-191	Wiener and Terminal Wiener Indices of Annihilator Graph of Commutative Ring with Unity	Nur Dana Novi Yanti Salma	G
85	ABS-193	Creating Batik patternsthrough The Modification of Mandelbrot Set	Sely Ayu Rahmasari	G
86	ABS-197	The Description of the Fuzzy Sets Operations In Lattice Theory	Lailatul Maziyah W.M.	G
87	ABS-207	Decision support system to determine the level of damage and losses after a disaster using a weighted product	Umi Madinatul M	G